

Installation

1. Take off the screws, then remove the metal support bracket from the unit. As shown in the first illustration.
2. Tighten the metal support bracket to the ceiling of vehicle as shown in the second illustration, and leave a certain space to let the connecting wire pass through. (Take extra care to unbroken the ceiling of vehicle).
3. To install the unit to the metal support bracket, connecting with the unit and the wires passing through the remain space.

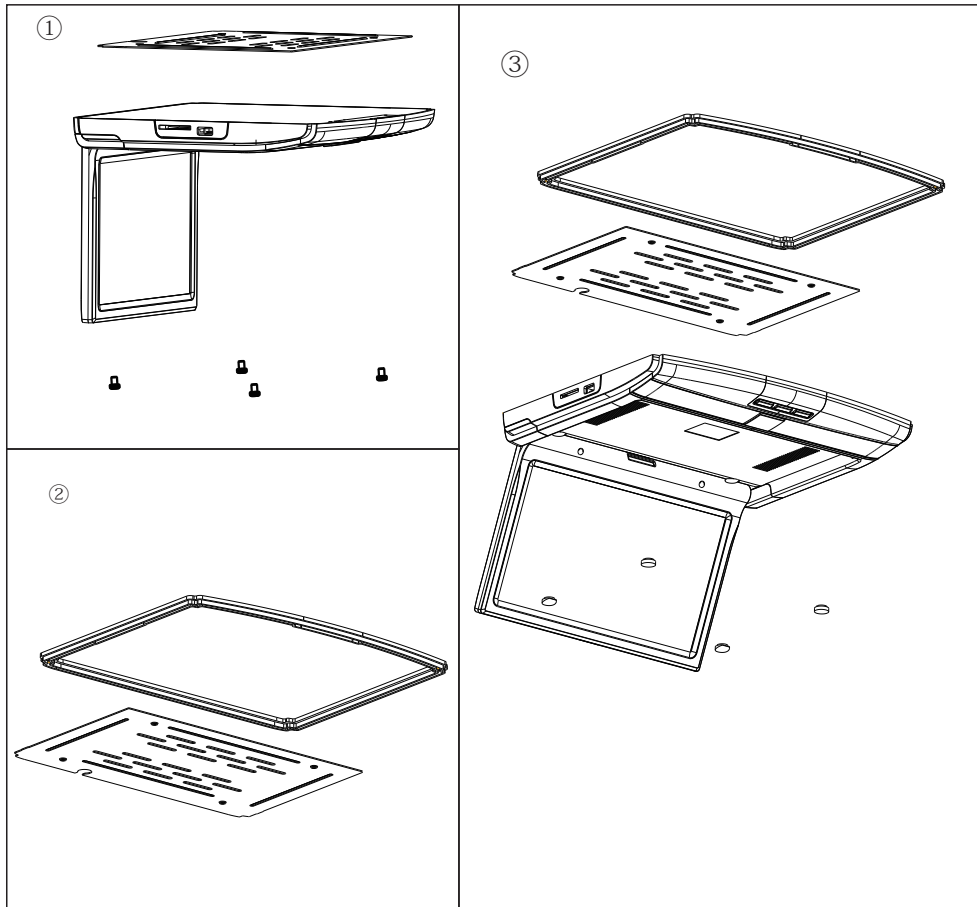

15.6''&17.3'' ROOF MOUNT MONITOR



**OPERATING
INSTRUCTIONS**

Appearance and function

- ①.Open
- ②.Light switch
- ③.Analog+
- ④.MENU
- ⑤.Analog-
- ⑥.Power switch/AV Switch
- ⑦.Standby

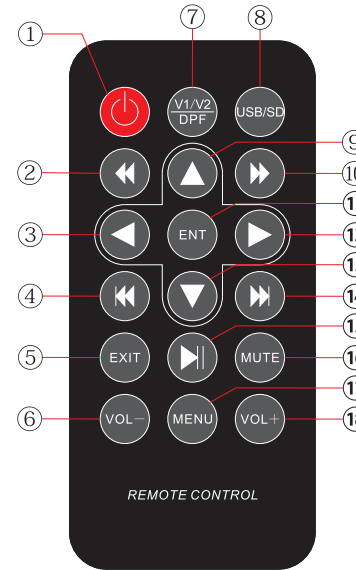

- ①Power on/off
- ②Back rewind
- ③Left
- ④Last song
- ⑤Exit
- ⑥Volume-
- ⑦AV switch
- ⑧USB/SD switch
- ⑨Up
- ⑩Forward rewind
- ⑪Enter
- ⑫Right
- ⑬Down
- ⑭Next song
- ⑮Play/Pause
- ⑯MUTE
- ⑰MENU
- ⑱Volume+

Specifications

- 15.6"&17.3"Flip Down Monitor
- Resolution:15.6inch:1920×1080
- 17.3inch:1920×1080
- Display mode: 16:9
- Built-in IR/FM Transmitter
- with USB/TF/HDMI input
- 2Video inputs,1 audio input
- Built in Roof Lights
- Wireless Remote Control
- Power Supply:DC 12V / 24V

Wiring Diagram

