

Carbon Fibre Auto Seat Heating System Installation Manual



SGS

Please read through instructions carefully before installation.

No. ATTENTION

- 1 Never fold the pad on itself
- 2 Never cut the pad lengthways if you need two halves please use the 4 pad version
- 3 Never run the heated seats without running the engine as this will flatten the battery
- 4 Never put hot or sharp objects on the pad
- 5 Please be aware of cars with side airbags, the company will not take responsibility if an airbag erupts

Please see below the set up for the heating pad.

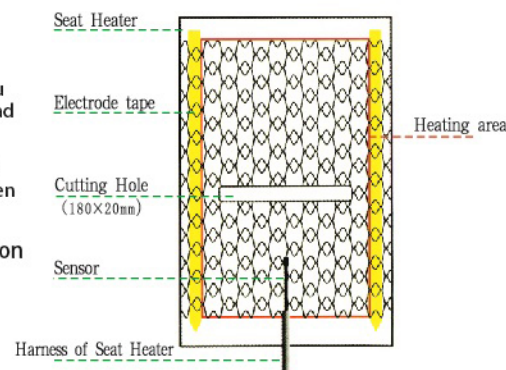

Pic.1 Structure of Carbon Fibre Heating Pad

Cutting the Pad

1. If you need to cut a hole in the pad the maximum size hole is 180mm by 20mm (see pic.1 for details) this should leave 25mm between the hole and the electrode tape. You can only cut the pad horizontally, it can not be cut vertically. Be careful not to damage the electrodes as this will cause the heated seat to malfunction. If the pad is too long you can cut up to 1/3 (150mm) off the side opposite the wiring harness, do not exceed this amount. Insulate the cut edges well.
See below on how not to cut the heating pads.

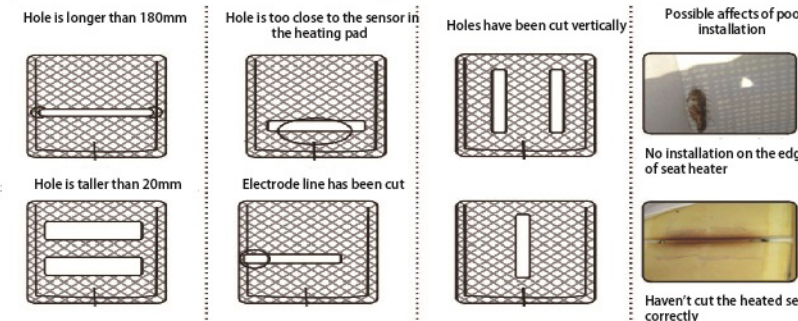

Installation Steps

1. First start by removing the seat from the vehicle and placing it on a suitable work bench. Remove the upholstery from the seat and lay the pad on to confirm the position and if it needs cutting (please refer to 'cutting the pad' for correct cutting method)
2. Fully insulate any metal frame using PVC tape to avoid causing a short. Lay the pad with the adhesive side facing the foam. Use the hog rings supplied to hold pad and metal frame down.

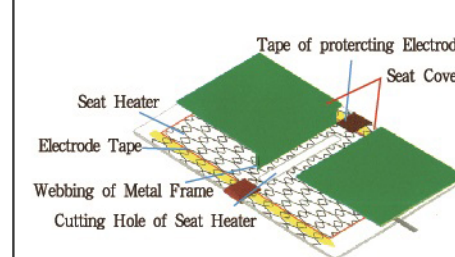

Pic.2 Cut hole & Tape of Protecting Electrode

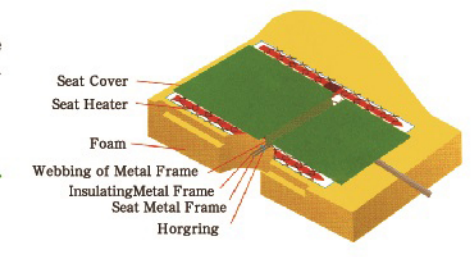

Pic.3 Metal Frame disposal

3. Remove the covering paper and thoroughly glue the edges of the pad to the foam. Run the cable to a convenient position below the seat.

4. Seat may now be recovered with the upholstery.

5. Always use the fuse assembly provided with the wiring harness in order to protect the circuits. If the fuse blows only replace it with a 10A fuse.

6. Before installation of the wiring remove the negative terminal of the battery to prevent any chance of a short.

7. It is recommend you run the power lead to the vehicles fuse box, use a circuit which is only on when the ignition is on, failure to do so will drain the battery if the seat heater is left on while the engine is not running.

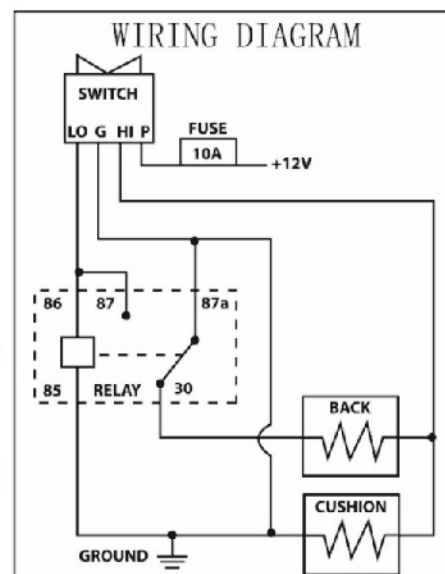

8. Ground the wiring harness on a suitable location on the car chassis. If needed remove a little bit of paint to give the best possible connection.

9. The switch may now be installed in the vehicle dash, centre console or plastic of the seat. You will need to use a 20mm hole cutter to make the correct size hole.

10. Plan the location of the switch carefully, consider ease of access for the vehicle occupant/s and for routing the wires safely. Check for wiring harnesses, ducting, structural parts and obstructions behind where you are drilling.

11. The seat may now be returned to the car, reconnect the battery and test the heated seat is functioning correctly.

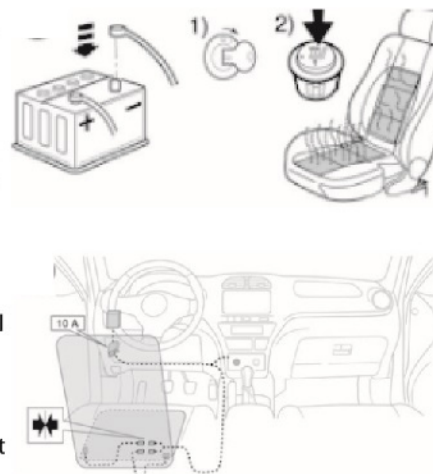

Troubleshooting

No	Fault	Possible Cause(s)
1	No light on switch, system does not work	Check all power connections
2	Light on, system does not work	Check main power lead, fuse
3	Light on, pads not heating up	Check ignition wire
4	Light on, a certain seat is not hot	Check heat controller, heating pad
5	Light on, seat is not hot enough	Check heat controller, heating pad
6	Light on, seat is too hot	Check heat controller, heating pad
7	After powering up fuse keeps blowing	Check wiring for no short circuits, heat controller

GENERAL INSTALLATION GUIDELINES:

- 1. Be careful working with seat belts, air bags and occupant sensors, follow instructions in vehicle shop manual.
- 2. Seat is heavy, awkward, and has sharp edges, take care when removing and handling seat.
- 3. All seat adjustments (seat track, height adjustments, back recliner, armrest and headrest positions) must be in proper working order before returning the seat to the vehicle.
- 4. Properly tighten the bolts holding the seat in place according to the vehicle manufacturer's torque specification noted in the vehicle shop manual.
- 5. Secure heating pad to seat foam using the peel and stick adhesive already on the pad. The adhesive must be placed on the seat foam sticky side down, do not attach the heating pad to the upholstery.

Seat Heater Kit

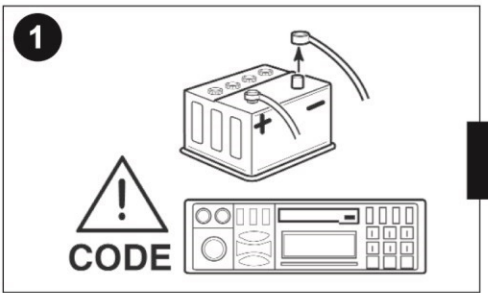

Disconnect battery ground cable.
Note: Write down radio security codes and station pre-sets.



Remove seat and place on work bench for easy access.

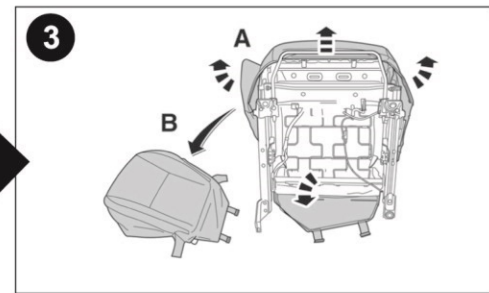

Remove lower seat cover.

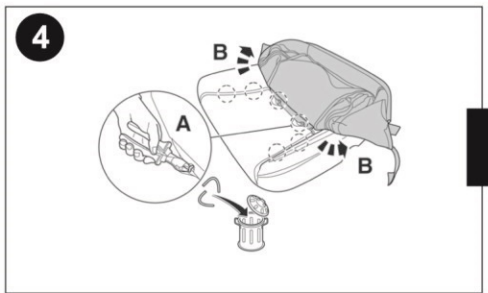

Remove old heating pad (if so equipped), note position of electrical wiring and openings in pad.

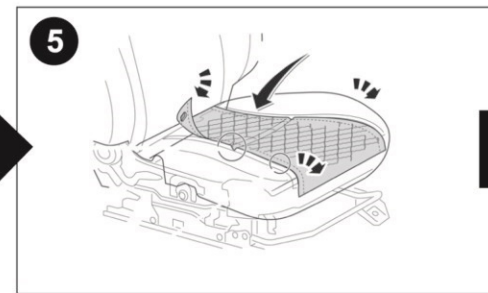

Install new pad, peel & stick adhesive.
Note: Be sure to route wiring to back of seat cushion, away from center of seat.

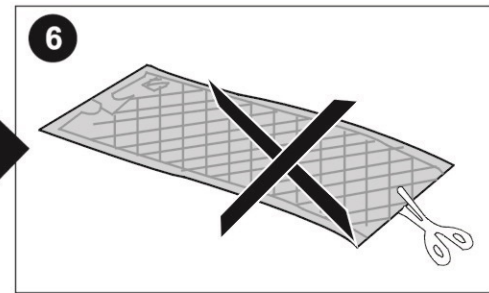

Do not cut vertically or fold



Remove seat back cover, and remove old heating pad (if so equipped).
Note: Slide cover up only as far as needed to install seat heater pad.



Install new pad, peel & stick adhesive.
Note: Be sure to route wiring to bottom of seat back, away from center of the seat.

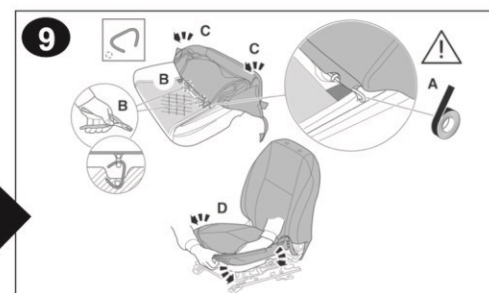

Replace cover - (clips, Velcro® and hog rings).

For new installations, (not replacement pads) follow step 10 instructions

ADDITIONAL WIRING INSTRUCTIONS

FOR NEW INSTALLATIONS:

- 1. The fuse assembly provided must be used in order to protect the electrical circuit of the seat heater kit.
- 2. It is recommended that the installation connect to a circuit in the vehicle's fuse panel using the included fuse-tap device.
- 3. The seat heater must be connected to an electrical circuit that is on only when the key is in the "run" position. Failure to connect to a switched circuit will drain the battery if the seat heater is left on while the engine is not running.
- 4. Switch may be installed on the dash, center console or plastic seat skirt. Use a 25/32" (20mm) drill to make the hole for the switch.
- 5. Plan the switch location carefully for ease of access to the vehicle occupant, and for the routing of the wires. Check for other wire harnesses, ductwork, structural parts and obstructions before drilling holes in dash, console or plastic seat skirt.
- 6. Secure relay behind dash using cable ties to prevent vibration noise.

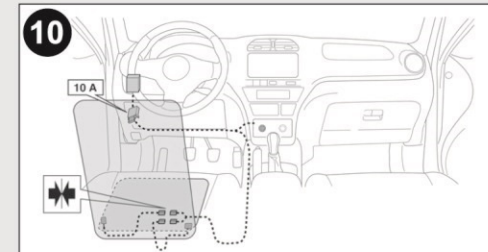

Layout wiring for connection before installing seat. Connect fuse tap to a fuse that is on with key in "Run" position to prevent battery drain when engine is off. Connect brown wire to solid metal ground point behind dash.

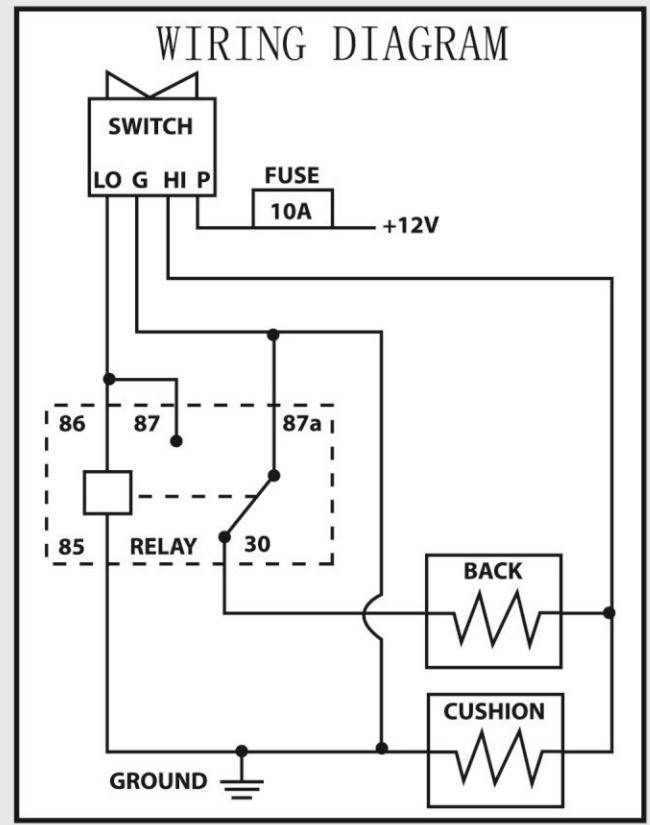

FINISH THE INSTALLATION:



Install seat - apply proper torque on all seat fasteners. Make sure seat track is clear and all seat height and seat back adjustments are free to move.

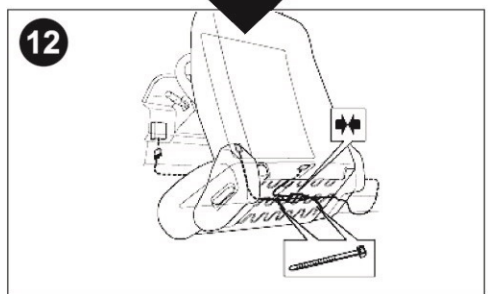

Reconnect all seat electronics, secure wiring with cable ties to prevent tangling with seat track.

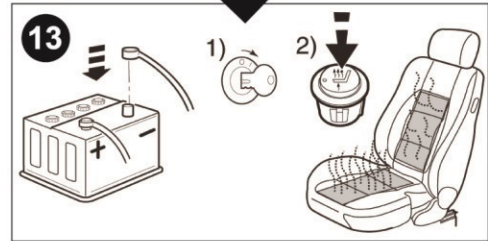

Reconnect battery and test operation of the seat heater.

Technical Data:
Voltage: 12V
Temperature Range: 30°C~70°C
Size: 550mm x 280mm;
450mm x 280mm
Material: Carbon Fiber

Auto Seat Heater Installation Instructions

Please read installation instructions carefully, check and amount encasement bill.

ATTENTION

NO.	ITEM
1	Never fold installation
2	Never damage two sides electrode tape in heating area.
3	Never cut along electrode length direction in heating area.
4	Never shear the heating wire of sensor and the thermostat.
5	Never run the seat heater without running the engine, it can cause to strain the battery.
6	Never put hot and sharp articles on electrifying seat.
7	Never sprinkle electric liquid on the seat.
8	Cars fitted with side airbags have to be treated carefully, if cause airbags to erupt, our company will not undertake the responsibility.

For example, Five-gear switch, Carbon fibre auto seat heating pad

一、Installation Steps of Carbon Fibre Seat Heating Pad:

1、Seat Disassembly:

Dismantle the auto seat, record the order and keep the components.

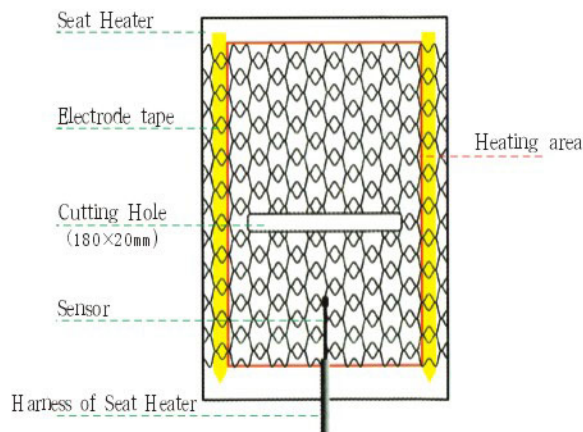

Pic.1 Structure of Carbon Fibre Heating Pad

2. Structure of Carbon Fibre Heating Pad:

Look at Pic. 1. This is the heating area between two electrode tapes. Cut 180mm 20mm hole. There will be about 25 mm of free space between edge of hole and electrode. Do not damage electrode. If seat heating pad is too long, you can cut from one side without wiring harness. Do not cut between hole and wiring harness. Cutting length can not exceed $\frac{1}{3}$ of the whole. Insulate with black adhesive tape. Pic. 1

3. Confirm Position:

Firstly, confirm laying position of seat heater and metal frame position. Sensor of seat heater not be installed in a recessed area

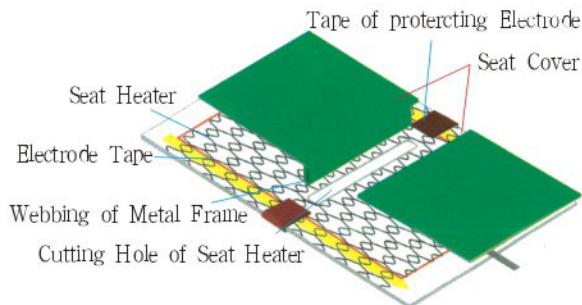

Pic.2 Cut hole & Tape of Protecting Electrode

4. Metal Frame disposal:

Ake out metal frame to insulate with PVC tape. Cutting webbing of metal frame is the same long as hole length. Pic. 2

Seat heater with adhesive tape face to cushion and back. Webbing crosses the hole. Then put insulating metal frame in webbing. Fix insulating metal frame and metal frame in the seat foam with hog ring.

Electrode next to the joints, it is easily damaged by metal frame, so adhibit the tape to protect electrode. Pic. 3

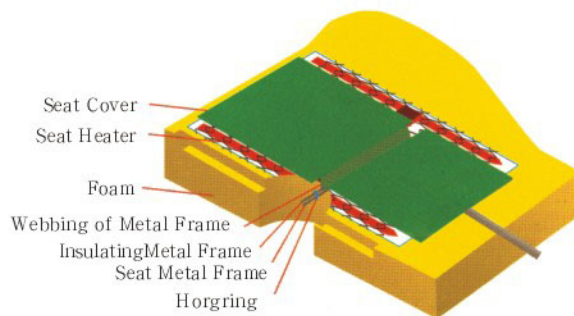

Pic.3 Metal Frame disposal

5. Lay the Seat Heater:

Remove the covering paper and thoroughly glue the element on top of the foam beginning with the already glued front end. The wiring harness can be run at a convenient position below the seat. Connect it and main wiring harness.

6. Recover:

Re-attaching the cover, according to disassembly order to install seat. Finish the seat heater installation.

二、Installation Wiring Harness

Close ignition switch. Install harness after disassembly seat.

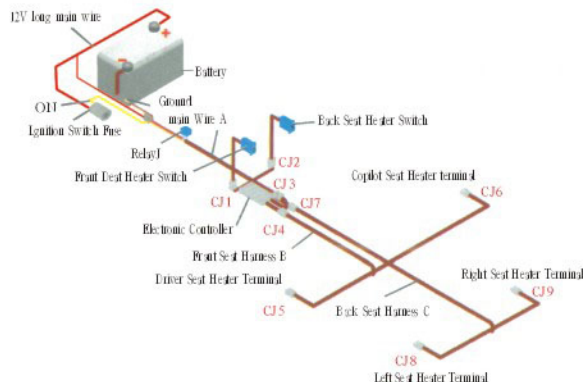

Pic. 4

1、Installation switch

Choose a suitable position with paste as the same size as switch. Bore along the paste and trim edge until the hole size is suitable for switch.

2、Installation Wiring Harness A Pic.4

(1) +12V power connection method

Under switchboard and panel, measure the most thick main wire with 20V DC of multimeter .

Strip 25mm of both long main wire and red wire of main harness A. Insulation with black adhesive tape after enlacing and fixing. Pic. 5

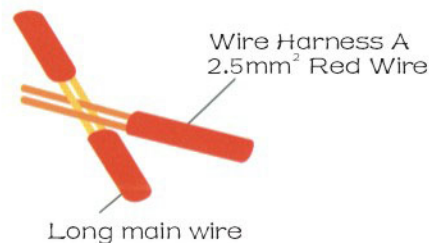

(2) ON wire of Ignition Switch connection method

Choose ON wire with multimeter

(Note: Having 12V voltage when key is in ON wire position. Close ignition switch, it has not.)

Strip 25mm of both ON wire and red wire of main harness A. Insulation with black adhesive tape after enlacing and fixing.

(3) Ground wire connection method

Find electric ground screw. It has not plastic pad on grounding screw. It has not oil paint and rust on grounding screw. If has, clean them. Ground wire of main wire harness A must fix on the ground screw with nut. Never cut copper washer to connect.

(4) The fuse, the relay and controlling box are fixed on the place which is easy to dissipate the heat. Note: Keep away from air-heating engine. Wiring harness A should keep away from connecting rod of accelerator. According to terminal label to connect A wiring harness and terminal CJ3 of electron controller.

3. Installation Wiring Harness B&C

(1) According to label to connect electron controller and terminal CJ4 of the Wiring Harness B.

(2) Wiring Harness B pass through carpet to connect two terminals about terminal CJ5(Left seat) and terminal CJ6(Right seat). Wiring harness of copilot must round to panel to connect terminal CJ6.

(3) According to label to connect electron controller and terminal CJ7 of the C Wiring Harness.

Wiring Harness C pass through carpet to connect two terminals about CJ8(Left seat) and CJ9(Right seat).

Note: Wiring Harness should keep away from slide of front seat and metal structure of back seat.

三、Series Products

12V Series

Five gear switch Five gear knob switch High/low temperature switch Single gear switch Autoloading switch

24V Series

High/low temperature switch

Single gear switch

IV、Common Malfunction and Cause(s)

NO.	Common Malfunction Phenomena	Possible Cause(s)
1	After electrifying, switch has no pilot lamp. System does not work.	Red-yellow ON wire, Terminal of gear switch, Ground wire, Gear switch.
2	After electrifying, switch has pilot lamp. System does not work.	Long red main wire, Fuse, Relay, Terminal, Electron controller.
3	After electrifying, switch has pilot lamp. Front/back seat is not hot.	Gear switch, Terminal of gear switch
4	After electrifying, switch has pilot lamp. A certain seat is not hot.	Electron controller, Seat terminal, Seat heater
5	After electrifying, switch has pilot lamp. Temperature of a certain seat is low.	Electron controller, Seat terminal, Hot protector, Seat heater
6	After electrifying, switch has no pilot lamp. Temperature of a certain seat is high.	Gear switch, Electron controller, Sensor of seat heater, Hot protector
7	After electrifying, switch has pilot lamp. The fuse is always burnt out.	Electron controller, Seat heater

Attachment

Encasement Bill (Five-gear switch— whole vehicle type)

Part Name Products Type Quantity	Cushion Heat Element	Back Heat Element	Control Harness	Electron Controller	Switch	Switch paste(as the same size as switch)	Tape of protect- ing electrode	Nylon Cable Ties	Hog ring	Certificate	Instruction	Voltage	Remark
poly-gear button seat heater-whole vehicle type	4	4	4	include switch	2	2	16	4	32	1	1	12V	
poly-gear button seat heater-Front seat type	2	2	2	include switch	1	1	8	2	16	1	1		
Five-gear switch seat heater-whole vehicle type	4	4	3	1	2	2	16	4	32	1	1		
Five-gear switch seat heater-Front seat type	2	2	2	1	1	1	8	2	16	1	1		
High-Low Temp.seat heater(quadrate switch)	1	1	1	None	1	1	4	1	8	1	1		
High-Low Temp.seat heater(columniform switch)	1	1	1	None	1	1	4	1	8	1	1		
High-Low Temp.seat heater	1	1	1	None	1	1	4	1	8	1	1	24V	